

0 10M 20M

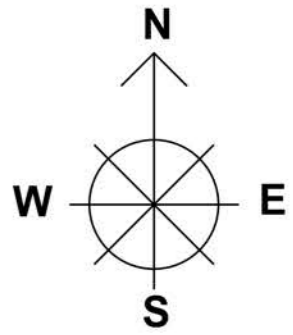



NOTE:  
RED LINE BOUNDARY DEMONSTRATES EXTENT OF PLANNING  
APPLICATION BOUNDARY  
SBC & RDC BOUNDARY DEMONSTRATED BY GREEN LINE

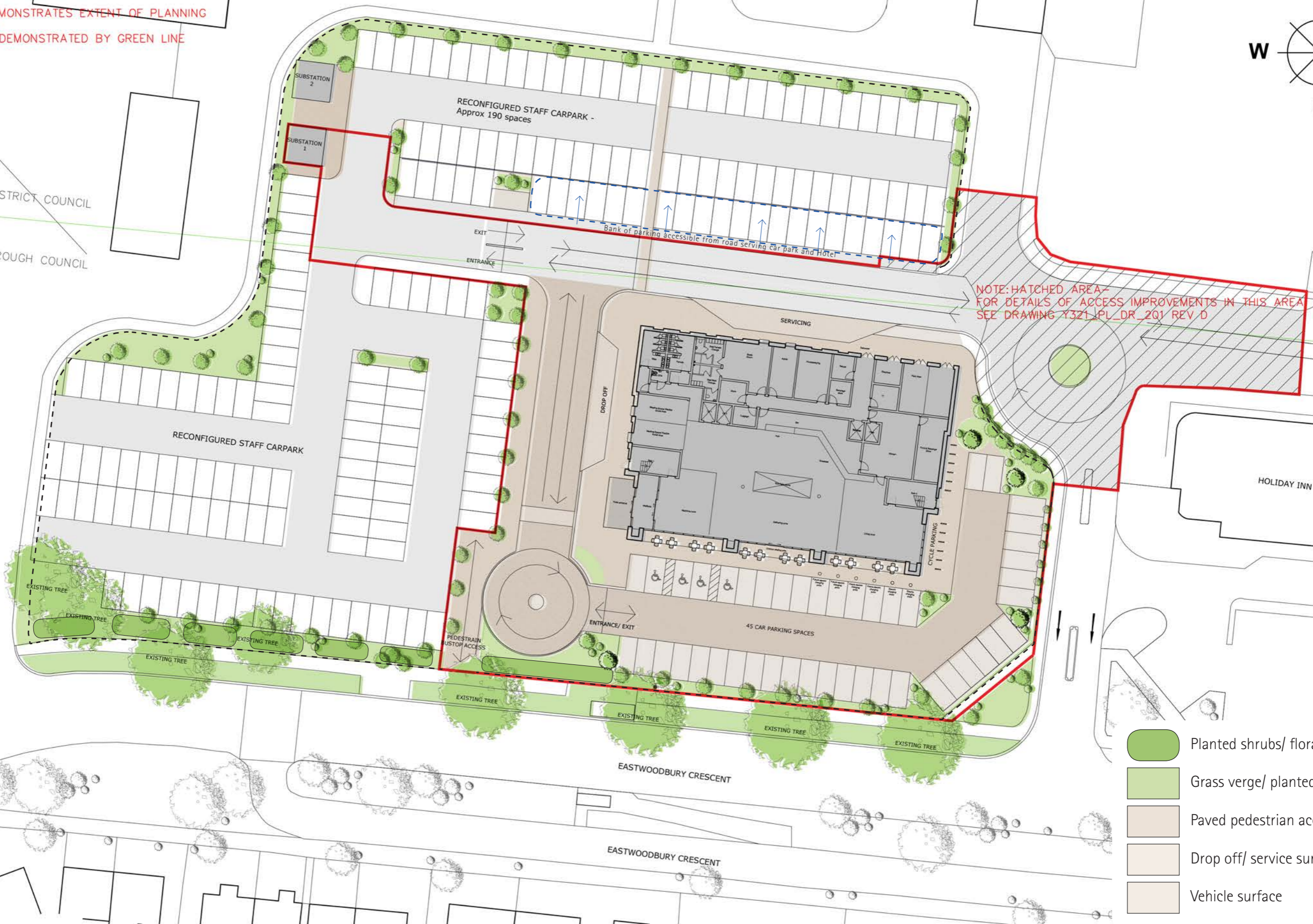

ROCHFORD DISTRICT COUNCIL

SOUTHEND BOROUGH COUNCIL

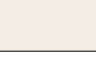

-  Planted shrubs/ floral bed
-  Grass verge/ planted
-  Paved pedestrian access area
-  Drop off/ service surface
-  Vehicle surface



**Aros Architects**  
Jerwood Space  
171 Union Street  
London SE1 0LN

**Telephone**  
+44(0)20 7928 2444  
**Facsimile**  
+44(0)20 7928 2450

**Email**  
info@arosarchitects.com  
**Website**  
www.arosarchitects.com

**Notes**

1. All dimensions are to be verified by the Contractor on site, any discrepancies in this drawing are to be reported to Aros Ltd
2. The Contractor shall not vary any work shown on this drawing without prior approval in writing from Aros Ltd.
3. The Contractor shall supply a full set of shop drawings and specifications prior to commencement of work.
4. This drawing supersedes all previous issues of the same drawing number with an earlier revision suffix.
5. The Contractor shall immediately inform Aros Ltd of the effect upon the programme and costs of any alterations to the proposed works shown on this drawing.
6. This drawing is the copyright of Aros Ltd and the contents must not be disclosed to other parties without prior agreement.

**Revisions**

Rev	Date	Drawn	Checked	Description
	XX.XX.XX			

**Project**  
London Southend Airport Hotel  
**Title**  
Proposed Landscape  
Master plan

<b>Project No</b> 6126	<b>Drawing No</b> (20) 002 (1)
<b>Date</b> March 2020	<b>Scale</b> 1:500 @ A3
<b>Status</b> Planning	<b>Rev</b> P5